

Shrink-Fit SRE SRS SRD

Small diameter Type

SRE



- High precision
 - High retentivity
- Shrinker chuck for cutting tool with a shank diameter of $\phi 3-8$. To be heated by induction heating device IH1500.

Slim Type

SRS



- High precision
- High retentivity
- Slim design

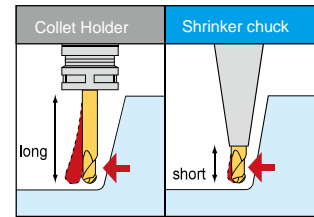

Heavy Type (DIN STANDARD)

SRD

- High precision
- High retentivity
- High rigidity



Advantages of Shrinker Chuck

High retentivity
The chucking torque is 2 - 4 times higher than that of Collet Holders.

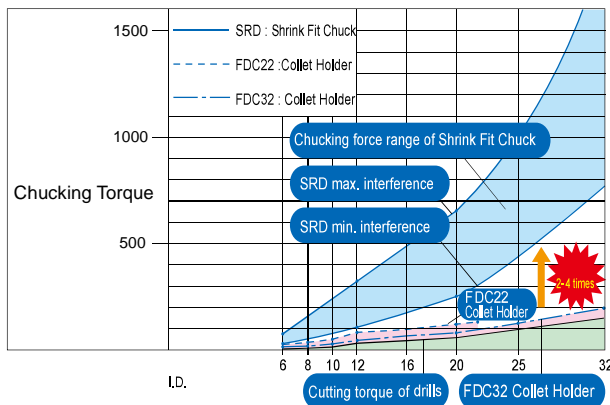

Superior Rigidity
Cutting tools with short shanks can be used. Increased rigidity, feed rates, speed, and longer tool life is achieved.

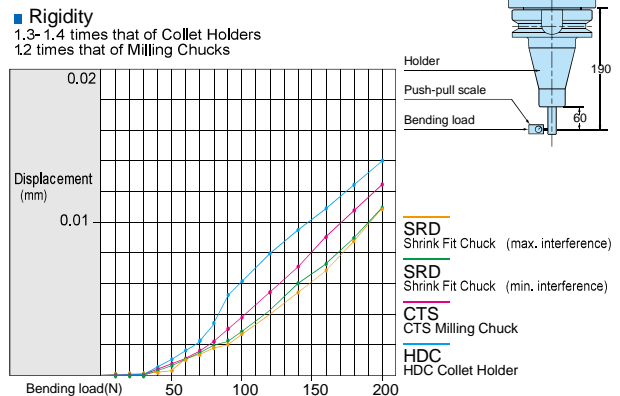

Shrink-Fit Holders CAT / SRE

Type 1

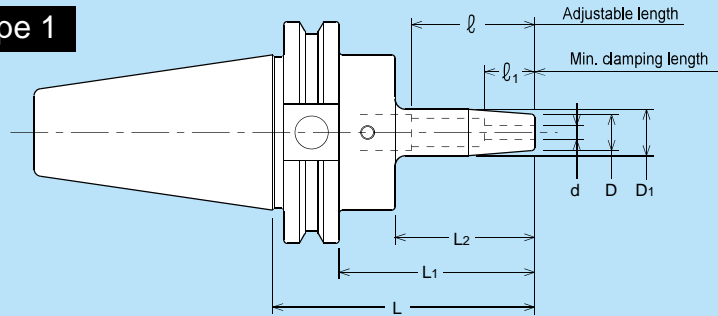

Type 2

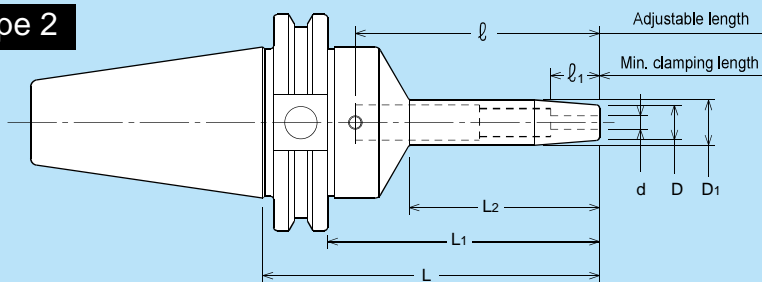

Model	Type	d (mm)	L	L ₁	L ₂	D	D ₁	D ₂	l ₁	l		
CAT40	-SRE3A	1	-60	2.362	1.612	0.982	0.453	0.650	1.750	0.512	1.024	
			-100	3.937	3.187	2.557					2.598	
			-120	4.724	3.974	3.344					3.386	
			-135	5.315	4.565	3.504					3.976	
			-160	6.299	5.549	4.488					4.961	
	-SRE4A	1	4	-60	2.362	1.612	0.982	0.453	0.650	1.750	0.630	1.024
				-100	3.937	3.187	2.557					2.598
				-120	4.724	3.974	3.344					3.386
				-135	5.315	4.565	3.504					3.976
				-160	6.299	5.549	4.488					4.961
	-SRE5A	1	5	-60	2.362	1.612	0.982	0.512	0.709	1.750	0.748	1.024
				-100	3.937	3.187	2.557					2.598
-120				4.724	3.974	3.344	3.386					
-135				5.315	4.565	3.543	3.976					
-160				6.299	5.549	4.528	4.961					
-SRE6A	1	6	-60	2.362	1.612	0.982	0.512	0.709	1.750	1.063	1.024	
			-100	3.937	3.187	2.557					2.598	
			-120	4.724	3.974	3.344					3.386	
			-135	5.315	4.565	3.504					3.976	
			-160	6.299	5.549	4.488					4.961	
-SRE8A	1	8	-60	2.362	1.612	0.982	0.512	0.709	1.750	1.063	1.024	
			-100	3.937	3.187	2.557					2.598	
			-120	4.724	3.974	3.344					3.386	
			-135	5.315	4.565	3.504					3.976	
			-160	6.299	5.549	4.488					4.961	

• Please use carbide shank tools with H6 tolerance.

Heating device chart

Holder	L ₁ ≤ 2.362	L ₁ > 2.362
IH1500 (page 105)	○	○
IH3200-N (page 107)	✗	○
SRK-HA1, HB2 (page 110)	✗	✗

Ordering Example

CAT40-SRE6A-120

Shrink-Fit Holders BT / SRE

Type1

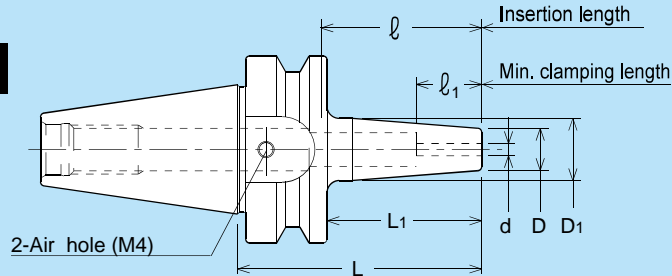

Type2

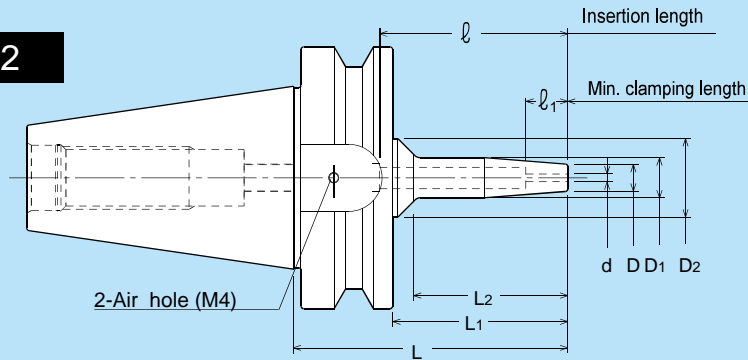

Model	Type	d (mm)	L	L1	L2	D	D1	D2	l ₁	l
-SRE3A	1	3	1.772	0.906			0.571			0.984
			2.362	1.496						1.575
			3.346	2.480						2.362
	2		4.134	3.268		0.453	0.650		0.512	3.150
			4.724	3.858	3.504					3.740
			5.709	4.843	4.528			1.181		4.724
-SRE4A	1	4	1.772	0.906			0.571			0.984
			2.362	1.496						1.575
			3.346	2.480						2.362
	2		4.134	3.268		0.453	0.650		0.630	3.150
			4.724	3.858	3.504					3.740
			5.709	4.843	4.488			1.181		4.724
-SRE5A	1	5	1.772	0.906			0.630			0.984
			2.362	1.496						1.575
			3.346	2.480						2.362
	2		4.134	3.268		0.512	0.709		0.748	3.150
			4.724	3.858	3.504					3.740
			5.709	4.843	4.488			1.181		4.724
-SRE6A	1	6	1.772	0.906			0.630		0.748	0.984
			2.362	1.496						1.575
			3.346	2.480						2.362
	2		4.134	3.268		0.512	0.709		1.063	3.150
			4.724	3.858	3.504					3.740
			5.709	4.843	4.488			1.181		4.724
-SRE8A	1	8	1.772	0.906			0.630		0.748	0.984
			2.362	1.496						1.575
			3.346	2.480						2.362
	2		4.134	3.268		0.512	0.709		1.063	3.150
			4.724	3.858	3.504					3.740
			5.709	4.843	4.488			1.181		4.724

Shrink-Fit Holders BT / SRE

Model	Type	d (mm)	L	L1	L2	D	D1	D2	ℓ ₁	ℓ	
BT40	-SRE3A	1	-50	1.969	0.906					1.063	
			-70	2.756	1.693		0.571		1.850		
			-100	3.937	2.874				0.512	3.031	
		2	-120	4.724	3.661		0.453		0.650	1.181	3.819
			-135	5.315	4.252	3.504					4.409
			-160	6.299	5.236	4.488					5.394
	-SRE4A	1	-50	1.969	0.906						1.063
			-70	2.756	1.693		0.571			1.850	
			-100	3.937	2.874				0.630	3.031	
		2	-120	4.724	3.661		0.453		0.650	1.181	3.819
			-135	5.315	4.252	3.504					4.409
			-160	6.299	5.236	4.488					5.394
	-SRE5A	1	-50	1.969	0.906						1.063
			-70	2.756	1.693		0.630			1.850	
			-100	3.937	2.874				0.748	3.031	
		2	-120	4.724	3.661		0.512		0.709	1.181	3.819
			-135	5.315	4.252	3.504					4.409
			-160	6.299	5.236	4.488					5.394
	-SRE6A	1	-50	1.969	0.906					0.748	1.063
			-70	2.756	1.693		0.630			1.850	
			-100	3.937	2.874				1.063	3.031	
		2	-120	4.724	3.661		0.512		0.709	1.181	3.819
			-135	5.315	4.252	3.504					4.409
			-160	6.299	5.236	4.488					5.394
-SRE8A	1	-50	1.969	0.906					0.748	1.063	
		-70	2.756	1.693		0.630			1.850		
		-100	3.937	2.874				1.063	3.031		
	2	-120	4.724	3.661		0.512		0.709	1.181	3.819	
		-135	5.315	4.252	3.504					4.409	
		-160	6.299	5.236	4.488					5.394	
BT50	-SRE3A	3	-75	2.953	1.457	1.102					1.772
			-90	3.543	2.047	1.693		0.571			2.362
			-120	4.724	3.228	2.874	0.453		1.181	0.512	3.543
		4	-135	5.315	3.819	3.504		0.650			4.134
			-160	6.299	4.803	4.488					5.118
			-75	2.953	1.457	1.102					1.772
	-SRE4A	4	-90	3.543	2.047	1.693		0.571			2.362
			-120	4.724	3.228	2.874	0.453		1.181	0.630	3.543
			-135	5.315	3.819	3.504		0.650			4.134
		5	-160	6.299	4.803	4.488					5.118
			-75	2.953	1.457	1.102		0.630			1.772
			-90	3.543	2.047	1.693				0.748	2.362
	-SRE5A	2	-120	4.724	3.228	2.874	0.512		1.181	0.748	3.543
			-135	5.315	3.819	3.504		0.709			4.134
			-160	6.299	4.803	4.488					5.118
		6	-75	2.953	1.457	1.102		0.630			1.772
			-90	3.543	2.047	1.693				0.748	2.362
			-120	4.724	3.228	2.874	0.512		1.181		3.543
	-SRE6A	6	-135	5.315	3.819	3.504		0.709		1.063	4.134
			-160	6.299	4.803	4.488					5.118
			-75	2.953	1.457	1.102		0.630			1.772
		8	-90	3.543	2.047	1.693				0.748	2.362
			-120	4.724	3.228	2.874	0.512		1.181		3.543
			-135	5.315	3.819	3.504		0.709		1.063	4.134
-SRE8A	8	-160	6.299	4.803	4.488					5.118	
		-75	2.953	1.457	1.102		0.630			1.772	
		-90	3.543	2.047	1.693				0.748	2.362	
	8	-120	4.724	3.228	2.874	0.512		1.181		3.543	
		-135	5.315	3.819	3.504		0.709		1.063	4.134	
		-160	6.299	4.803	4.488					5.118	

Heating device chart

Holder	L ₁ ≤ 2.362	L ₁ > 2.362
IH1500 (page 105)	○	○
IH3200-N (page 107)	✗	○
SRK-HA1, HB2 (page 110)	✗	✗

1. Please use carbide shank tools with h6 tolerance.
2. Please order 2 pcs of M4X5 hex screw to close the air hole on the holder.

Ordering Example

BT40-SRE6A-120

Shrink-Fit Holders H S K - A / S R E

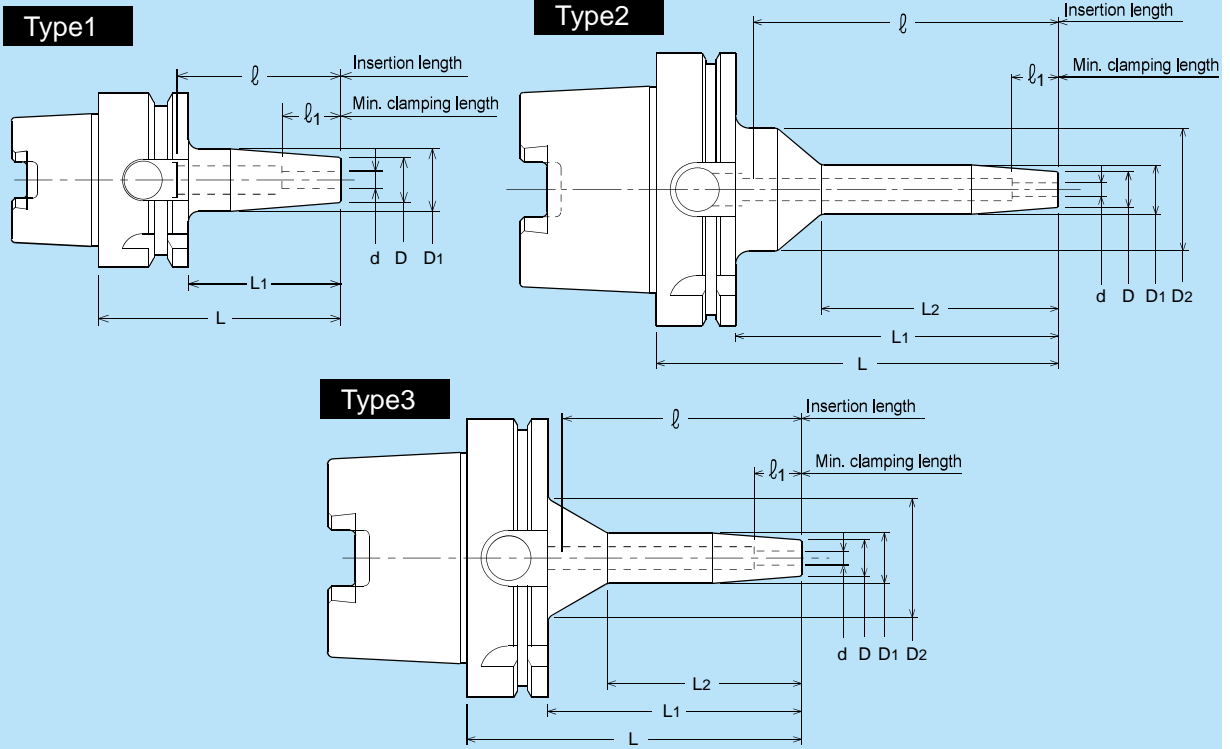

Model	Type	d (mm)	L	L1	L2	D	D1	D2	l ₁	l	
HSK40A	-SRE3A	3	-45	1.772	0.984			0.571		0.906	
			-60	2.362	1.575				1.496		
		1	3	-90	3.543	2.756				2.677	
				-115	4.528	3.74	0.453		1.181	0.512	3.661
		2	3	-135	5.315	4.528	2.913		0.65		4.449
				-150	5.906	5.118	3.504				5.039
	HSK40A	-SRE4A	4	-45	1.772	0.984			0.571		0.906
				-60	2.362	1.575				1.496	
			1	4	-90	3.543	2.756				2.677
					-115	4.528	3.74	0.453		1.181	0.63
		2	4	-135	5.315	4.528	2.913		0.65		4.449
				-150	5.906	5.118	3.504				5.039
HSK40A		-SRE5A	5	-45	1.772	0.984			0.63		0.906
				-60	2.362	1.575				1.496	
			1	5	-90	3.543	2.756				2.677
					-115	4.528	3.74	0.512		1.181	0.748
		2	5	-135	5.315	4.528	2.913		0.709		4.449
				-150	5.906	5.118	3.504				5.039
HSK40A	-SRE6A	6	-45	1.772	0.984			0.63		0.748	0.906
			-60	2.362	1.575				1.496		
		1	6	-90	3.543	2.756				2.677	
				-115	4.528	3.74	0.512		1.181	1.063	3.78
		2	6	-135	5.315	4.528	2.913		0.709		4.449
				-150	5.906	5.118	3.504				5.039
HSK40A	-SRE8A	8	-45	1.772	0.984			0.63		0.748	0.906
			-60	2.362	1.575				1.496		
		1	8	-90	3.543	2.756				2.677	
				-115	4.528	3.74	0.512		1.181	1.063	3.661
		2	8	-135	5.315	4.528	2.913		0.709		4.449
				-150	5.906	5.118	3.504				5.039

Shrink-Fit Holders H S K - A / S R E

Model	Type	d (mm)	L	L ₁	L ₂	D	D ₁	D ₂	ℓ ₁	ℓ	
HSK50A	-SRE3A	1	-50	1.969	0.945			0.571		0.906	
			-70	2.756	1.732					1.693	
			-90	3.543	2.520		0.453			2.480	
		2	-115	4.528	3.504			0.650	1.181	0.512	3.465
			-135	5.315	4.291	2.913					4.252
			-150	5.906	4.882	3.504					4.843
	-SRE4A	1	-50	1.969	0.945			0.571			0.906
			-70	2.756	1.732						1.693
			-90	3.543	2.520		0.453				2.480
		2	-115	4.528	3.504			0.650	1.181	0.630	3.465
			-135	5.315	4.291	2.913					4.252
			-150	5.906	4.882	3.504					4.843
	-SRE5A	1	-50	1.969	0.945			0.630			0.906
			-70	2.756	1.732						1.693
			-90	3.543	2.520		0.512				2.480
		2	-115	4.528	3.504			0.709	1.181	0.748	3.465
			-135	5.315	4.291	2.913					4.252
			-150	5.906	4.882	3.504					4.843
-SRE6A	1	-50	1.969	0.945			0.630		0.748	0.906	
		-70	2.756	1.732						1.693	
		-90	3.543	2.520		0.512				2.480	
	2	-115	4.528	3.504			0.709	1.181	1.063	3.465	
		-135	5.315	4.291	2.913					4.252	
		-150	5.906	4.882	3.504					4.843	
-SRE8A	1	-50	1.969	0.945			0.630		0.748	0.906	
		-70	2.756	1.732						1.693	
		-90	3.543	2.520		0.512				2.480	
	2	-115	4.528	3.504			0.709	1.181	1.063	3.465	
		-135	5.315	4.291	2.913					4.252	
		-150	5.906	4.882	3.504					4.843	
HSK63A	-SRE3A	1	-50	1.969	0.945			0.571			1.024
			-70	2.756	1.732						1.811
			-90	3.543	2.520		0.453				2.598
		2	-120	4.724	3.701			0.650	1.181	0.512	3.780
			-135	5.315	4.291	2.323					4.370
			-165	6.496	5.472	3.504					5.551
	-SRE4A	1	-50	1.969	0.945			0.571			1.024
			-70	2.756	1.732						1.811
			-90	3.543	2.520		0.453				2.598
		2	-120	4.724	3.701			0.650	1.181	0.630	3.780
			-135	5.315	4.291	2.323					4.370
			-165	6.496	5.472	3.504					5.551
	-SRE5A	1	-50	1.969	0.945			0.630			1.024
			-70	2.756	1.732						1.811
			-90	3.543	2.520		0.512				2.598
		2	-120	4.724	3.701			0.709	1.181	0.748	3.780
			-135	5.315	4.291	2.323					4.370
			-165	6.496	5.472	3.504					5.551
-SRE6A	1	-50	1.969	0.945			0.630		0.748	1.024	
		-70	2.756	1.732						1.811	
		-90	3.543	2.520		0.512				2.598	
	2	-120	4.724	3.701			0.709	1.181	1.063	3.780	
		-135	5.315	4.291	2.323					4.370	
		-165	6.496	5.472	3.504					5.551	
-SRE8A	1	-50	1.969	0.945			0.630		0.748	1.024	
		-70	2.756	1.732						1.811	
		-90	3.543	2.520		0.512				2.598	
	2	-120	4.724	3.701			0.709	1.181	1.063	3.780	
		-135	5.315	4.291	2.323					4.370	
		-165	6.496	5.472	3.504					5.551	

Shrink-Fit Holders H S K - A / S R E

Model	Type	d (mm)	L	L ₁	L ₂	D	D ₁	D ₂	ℓ ₁	ℓ			
HSK100A	-SRE3A	3	-90	3.543	2.402	1.535	0.453	0.650	1.614	0.512	2.323		
			-120	4.724	3.583	2.717					3.504		
			-150	5.906	4.764	2.323					4.685		
		2	3	-180	7.087	5.945	3.504		1.772		5.866		
				4	-90	3.543	2.402	1.535	0.453	0.650	1.614	0.630	2.323
					-120	4.724	3.583	2.717					3.504
	-150	5.906	4.764		2.323	4.685							
	-SRE4A	2	4	-180	7.087	5.945	3.504		1.772		5.866		
				5	-90	3.543	2.402	1.535	0.512	0.709	1.654	0.748	2.323
					-120	4.724	3.583	2.717					3.504
	-150	5.906	4.764		2.323	4.685							
	-SRE5A	2	5	-180	7.087	5.945	3.504		1.772		5.866		
				6	-90	3.543	2.402	1.535	0.512	0.709	1.654	0.748	2.323
					-120	4.724	3.583	2.717					3.504
	-150	5.906	4.764		2.323	4.685							
	-SRE6A	2	6	-180	7.087	5.945	3.504		1.772	1.063	5.866		
				8	-90	3.543	2.402	1.535	0.512	0.709	1.654	0.748	2.323
					-120	4.724	3.583	2.717					3.504
	-150	5.906	4.764		2.323	4.685							
	-SRE8A	2	8	-180	7.087	5.945	3.504		1.772	1.063	5.866		

- Please use carbide shank tools with h6 tolerance.

Heating device chart

Heating device	Holder	L ₁ ≤ 2.362	L ₁ > 2.362
IH1500 (page 105)		○	○
IH3200-N (page 107)		✘	○
SRK-HA1, HB2 (page 110)		✘	✘

Ordering Example HSK63A-SRE6A-120

Shrink-Fit Holders H S K - E / S R E

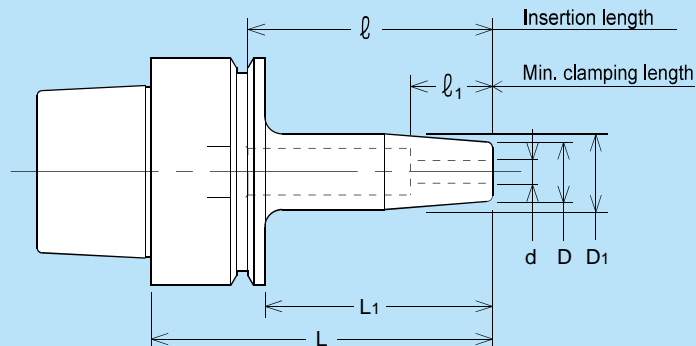

Model	d	L	L1	D	D1	l ₁	l	
HSK25E	-SRE3A	-35	1.378	0.984	0.453	0.571	0.512	0.787
		-50	1.969	1.575				1.378
	-SRE4A	-35	1.378	0.984	0.453	0.571	0.630	0.787
		-50	1.969	1.575				1.378
	-SRE5A	-35	1.378	0.984	0.512	0.630	0.748	0.787
		-50	1.969	1.575				1.378
-SRE6A	-35	1.378	0.984	0.512	0.630	0.945	0.787	
	-50	1.969	1.575				1.378	
-SRE8A	-35	1.378	0.984	0.512	0.630	0.748	0.787	
	-50	1.969	1.575				1.378	
HSK32E	-SRE3A	-45	1.772	0.984	0.453	0.571	0.512	1.102
		-60	2.362	1.575				1.693
	-SRE4A	-45	1.772	0.984	0.453	0.571	0.630	1.102
		-60	2.362	1.575				1.693
	-SRE5A	-45	1.772	0.984	0.512	0.630	0.748	1.102
		-60	2.362	1.575				1.693
-SRE6A	-45	1.772	0.984	0.512	0.630	1.063	1.102	
	-60	2.362	1.575				1.693	
-SRE8A	-45	1.772	0.984	0.512	0.630	0.748	1.102	
	-60	2.362	1.575				1.693	
HSK40E	-SRE3A	-45	1.772	0.984	0.453	0.571	0.512	1.102
		-60	2.362	1.575				1.693
	-SRE4A	-45	1.772	0.984	0.453	0.571	0.630	1.102
		-60	2.362	1.575				1.693
	-SRE5A	-45	1.772	0.984	0.512	0.630	0.748	1.102
		-60	2.362	1.575				1.693
-SRE6A	-45	1.772	0.984	0.512	0.630	1.063	1.102	
	-60	2.362	1.575				1.693	
-SRE8A	-45	1.772	0.984	0.512	0.630	0.748	1.102	
	-60	2.362	1.575				1.693	
HSK50E	-SRE3A	-50	1.969	0.945	0.453	0.571	0.512	1.220
		-70	2.756	1.732				2.008
	-SRE4A	-50	1.969	0.945	0.453	0.571	0.630	1.220
		-70	2.756	1.732				2.008
	-SRE5A	-50	1.969	0.945	0.512	0.630	0.748	1.220
		-70	2.756	1.732				2.008
-SRE6A	-50	1.969	0.945	0.512	0.630	1.063	1.220	
	-70	2.756	1.732				2.008	
-SRE8A	-50	1.969	0.945	0.512	0.630	0.748	1.220	
	-70	2.756	1.732				2.008	
		-90	3.543	2.520			0.709	2.795

Heating device chart

Holder	L ₁ ≤ 2.362	L ₁ > 2.362
IH1500 (page 105)	○	○
IH3200-N (page 107)	✗	○
SRK-HA1, HB2 (page 110)	✗	✗

• Please use carbide shank tools with h6 tolerance.

Ordering Example

HSK40E-SRE6A-120