

Simple Setter SPN (for BT shank)

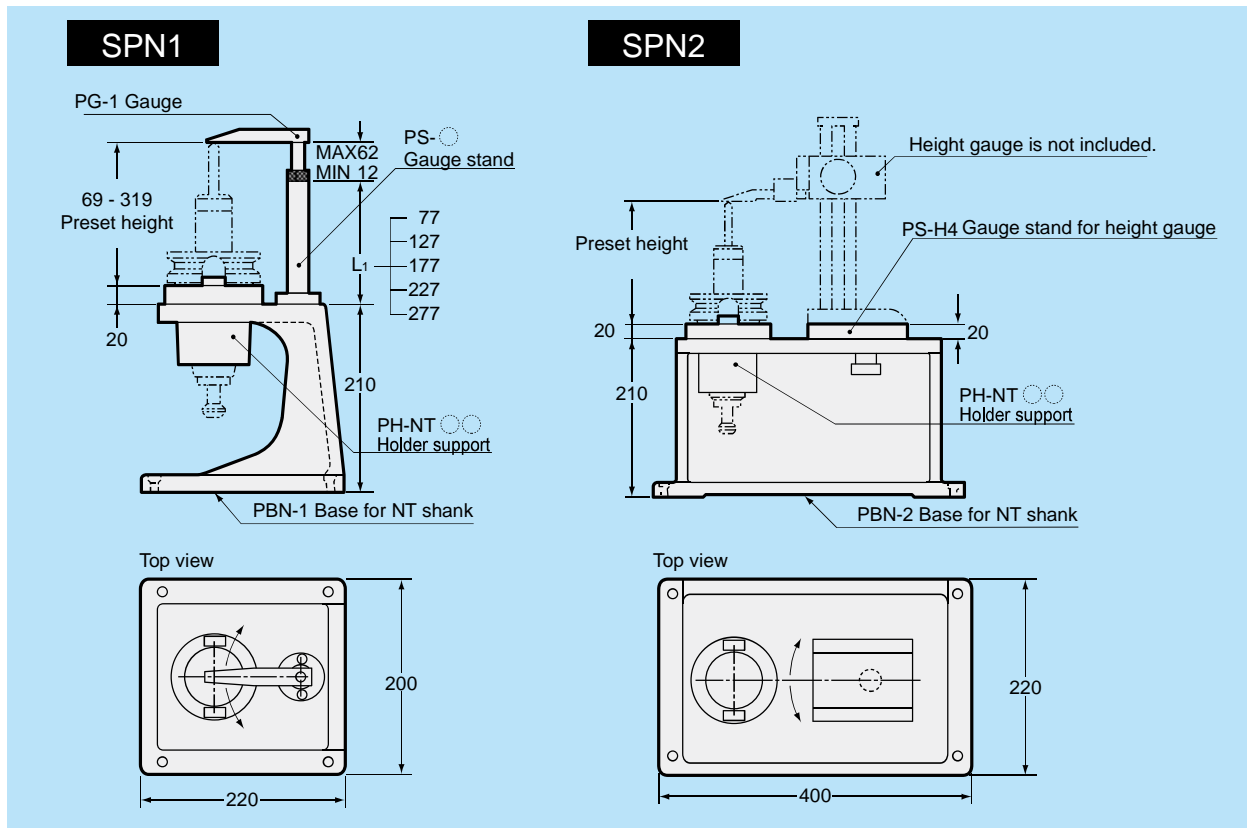

Gauge		Gauge stand		Holder support	Base	
PG-1	Conventional	PS-○	PS-H4	PH-NT ○ 24,000	PBN-1 ○	PBN-2 ○

Ordering Example

SPN1-NT40-227

SPN2-NT40+PS-H4

- All dimensions shown in millimeters.

Simple Setter SPN (for BT shank)

Gauge PG

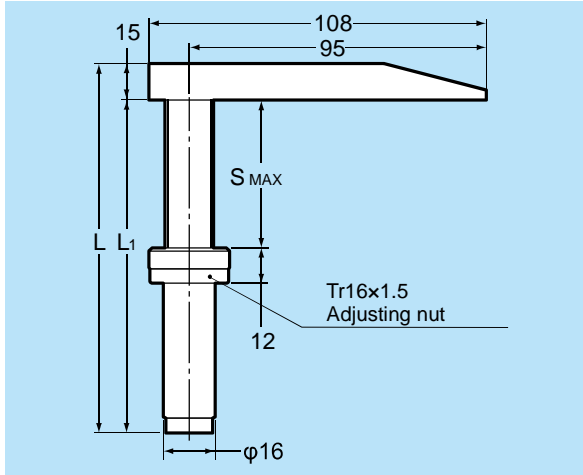

Model	L	L1	S _{MAX}	kg
PG -1	128	113	50	0.4

Gauge Stand PS

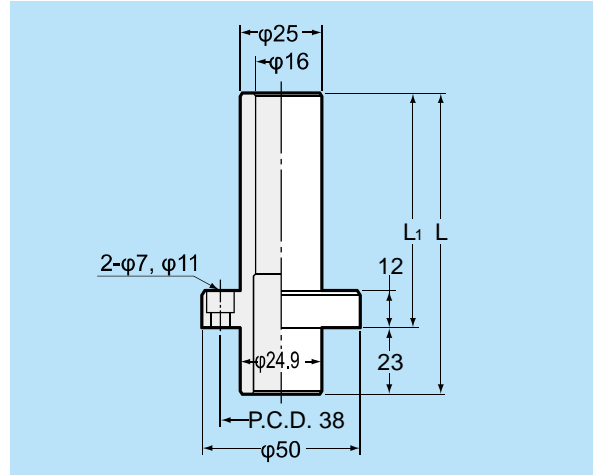

Model	L	L1
-1	100	77
-2	150	127
PS -3	200	177
-4	250	227
-5	300	277

Gauge stand for height gauge

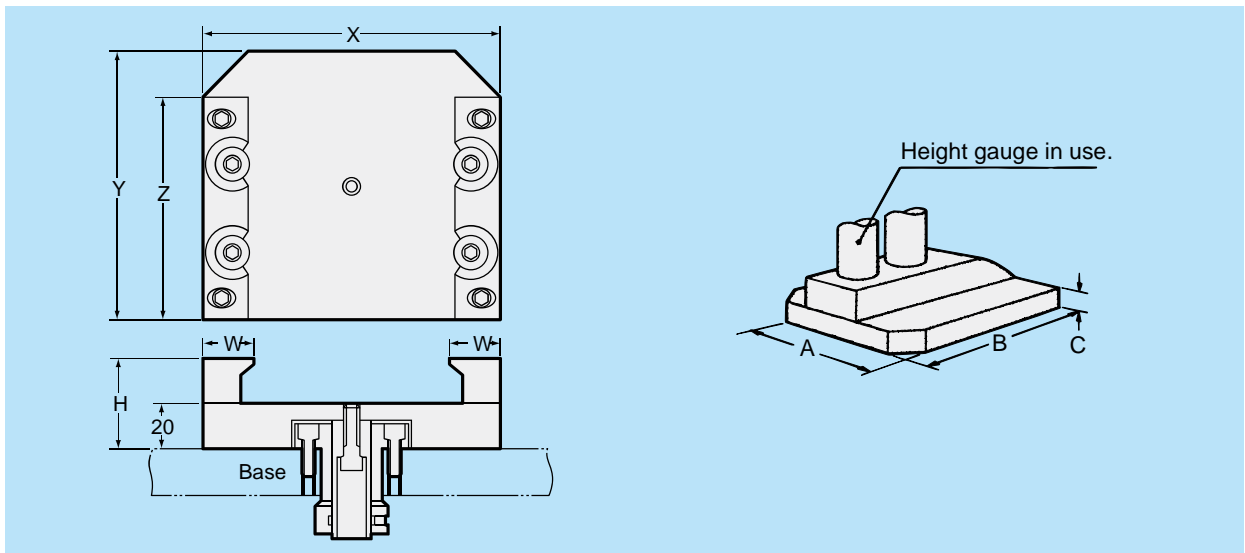

Model	X	Y	Z	W	H	A	B	C
PS-H4	136	135	110	21	37	91	135	12

1. When ordering special gauge stand, please let us know base dimensions AxBxC.
2. PS-H4 is used for Mitutoyo height gauge HD-30A or HW-30.

• All dimensions shown in millimeters.

Simple Setter SPN (for BT shank)

Holder support PH-NT

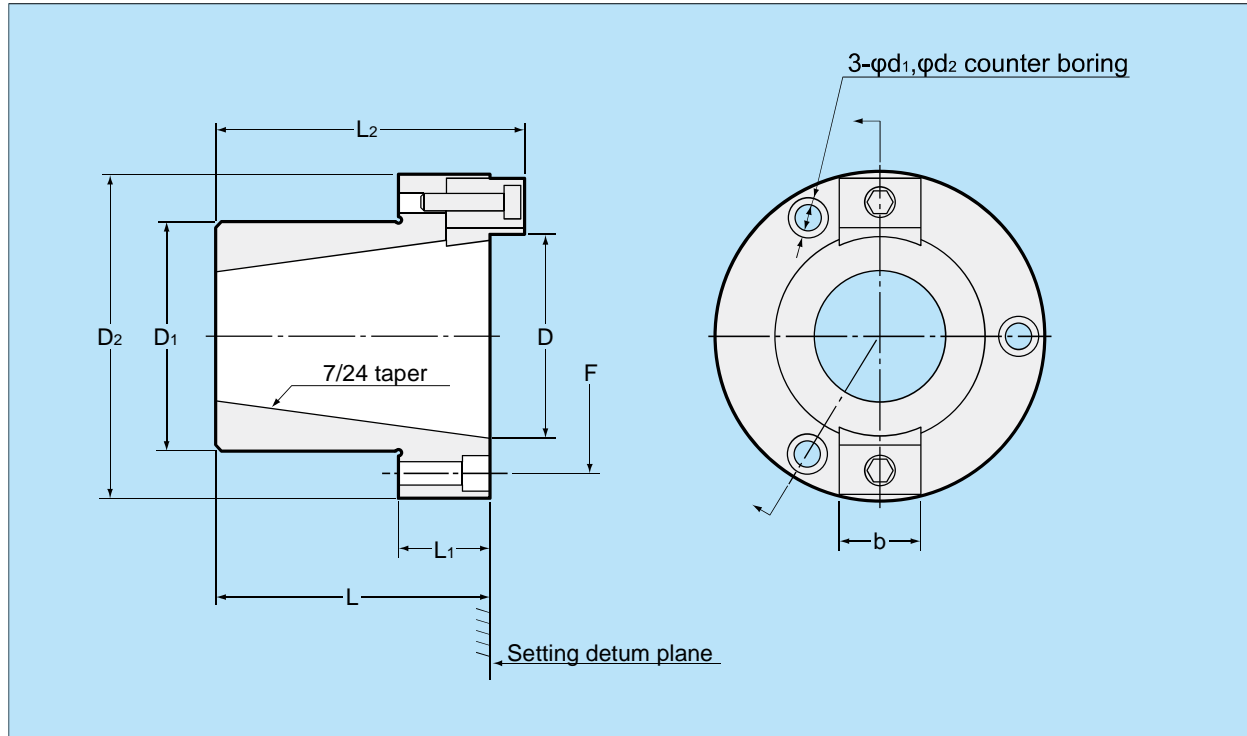

Model	D	D1	D2	L	L1	L2	F	b	d1	d2	kg
PH	-NT30	31.75	48	74	20	52	59	15.7	9	14	0.9
	-NT35	38.1									50
	-NT40	44.45	54	80		62	65	15.7			1.0
	-NT45	57.15	68	100		85	81	18.9			1.8
	-NT50	69.85	78	110		100	92	25.3			2.3

- All dimensions shown in millimeters.

Simple Setter SPN (for BT shank)

Base PBN

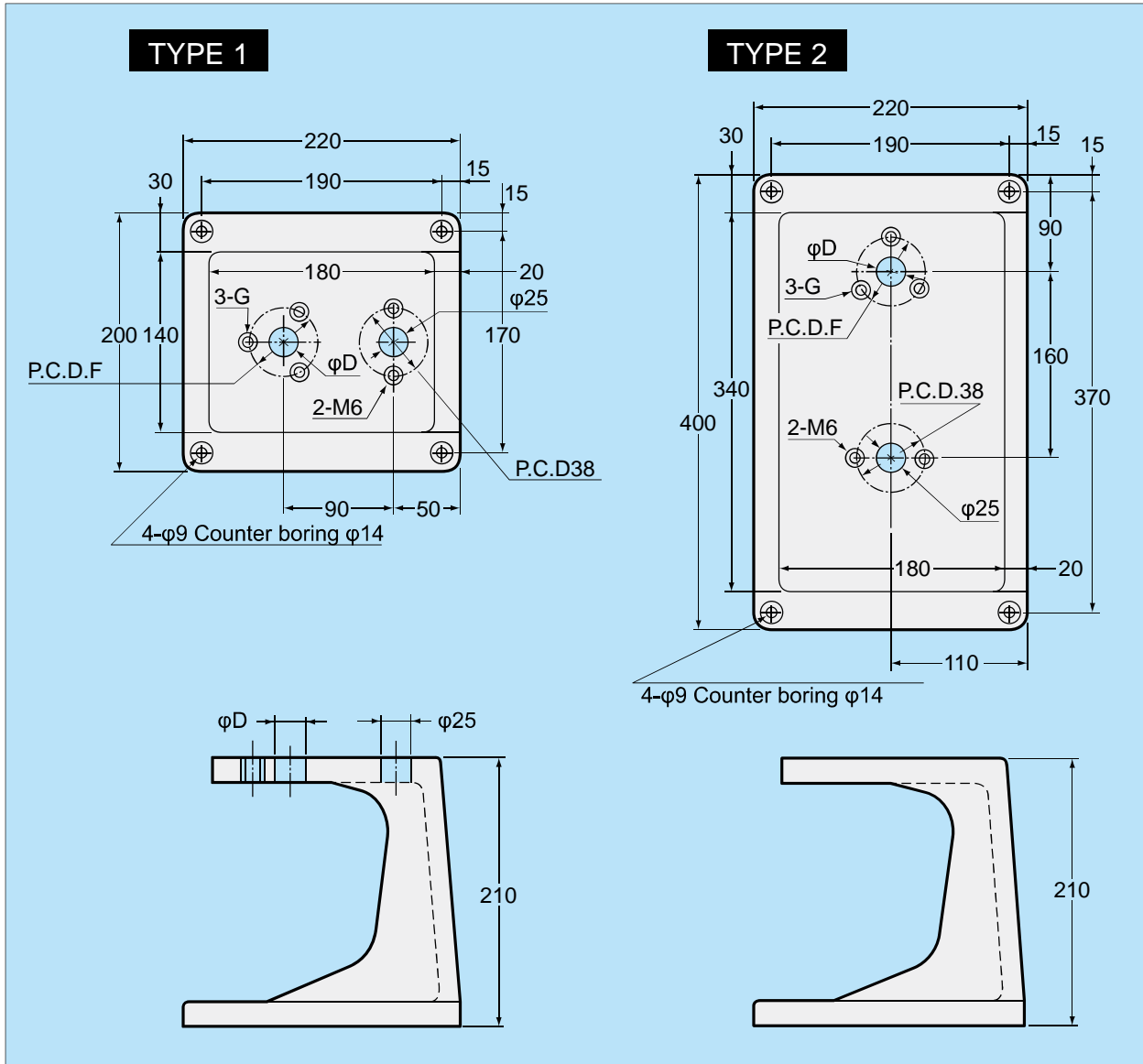

Simple Setter SPN (for BT shank)

Model	Type	ϕF	$\phi D^{+0.2}_0$	G	Holder support	Gauge stand
PBN	-1 - 30	59	48	M6	PH-NT30	PS-1 - PS-5 PS-H4
	-2 - 30					
	-1 - 35					
	-2 - 35					
	-1 - 40	65	54	M6	PH-NT40	
	-2 - 40					
	-1 - 45	81	68	M8	PH-NT45	
	-2 - 45					
	-1 - 50	92	78	M8	PH-NT50	
	-2 - 50					

• All dimensions shown in millimeters.

Simple Setter SPK-KHA (for KH-A, KH-E Stub Holder)

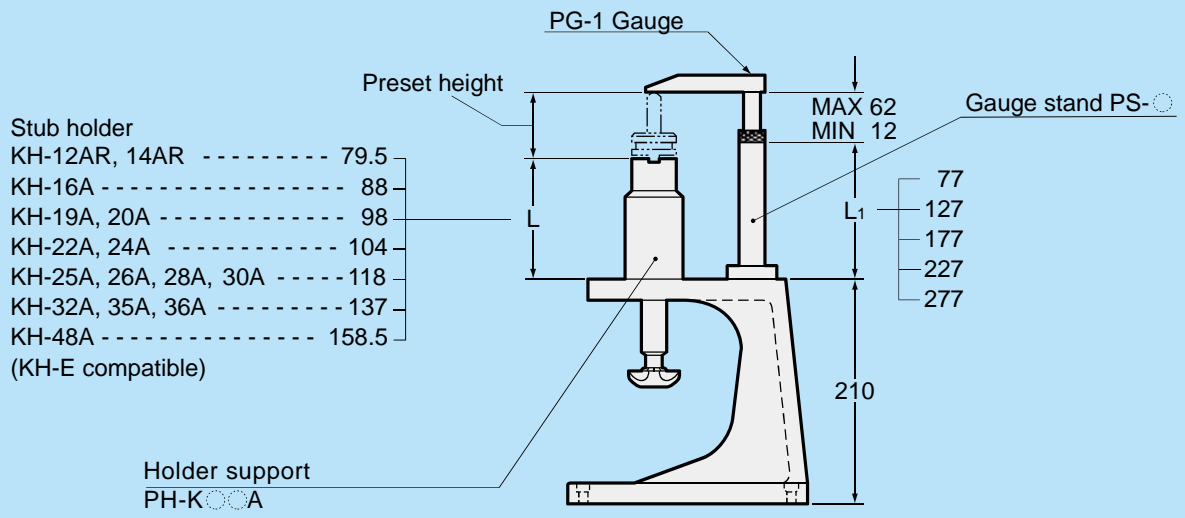

SPK1

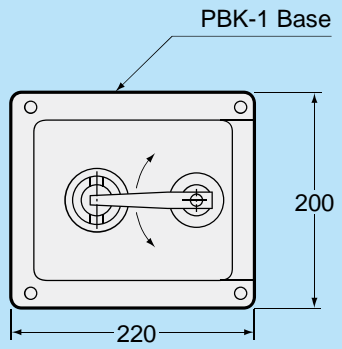

SPK2

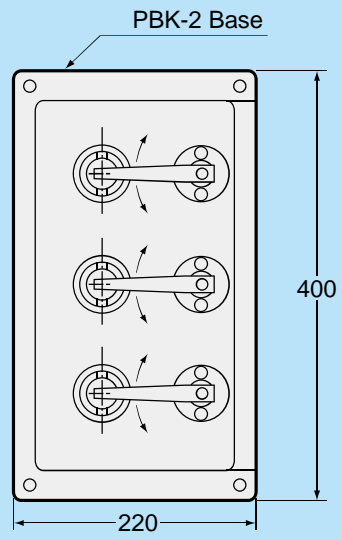

Gauge	Gauge stand	Holder support	Base
 PG-1	 PS-	 PH-KH	 PBK-1 PBK-2

Ordering Example SPN1-KH16A-77

- All dimensions shown in millimeters.

Simple Setter SPK-KHA (for KH-A, KH-E Stub Holder)

Gauge PG

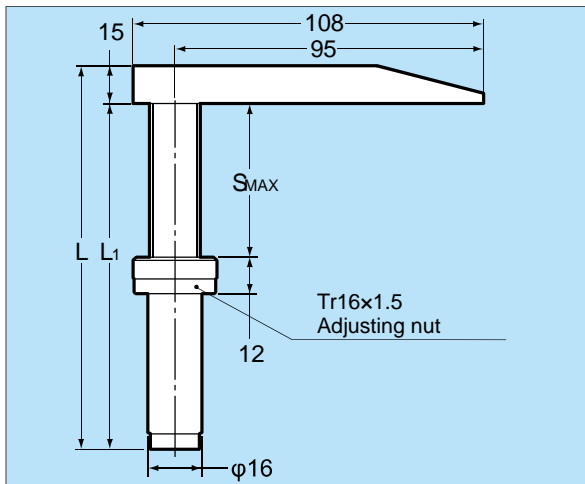

Model	L	L1	SMAX	kg
PG -1	128	113	50	0.4

Gauge stand PS

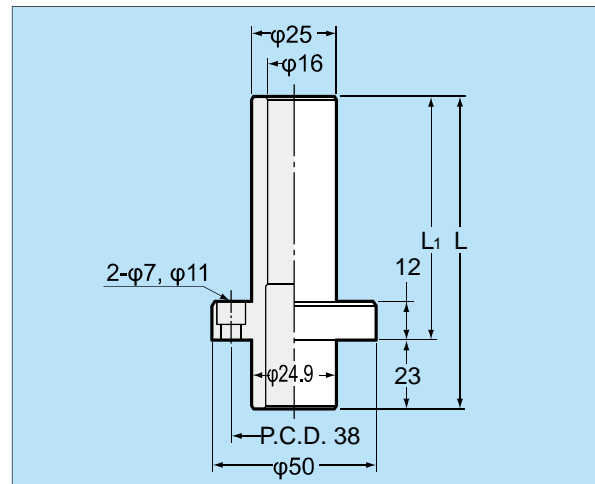

Model	L	L1
-1	100	77
-2	150	127
PS -3	200	177
-4	250	227
-5	300	277

Holder support PH-KHA

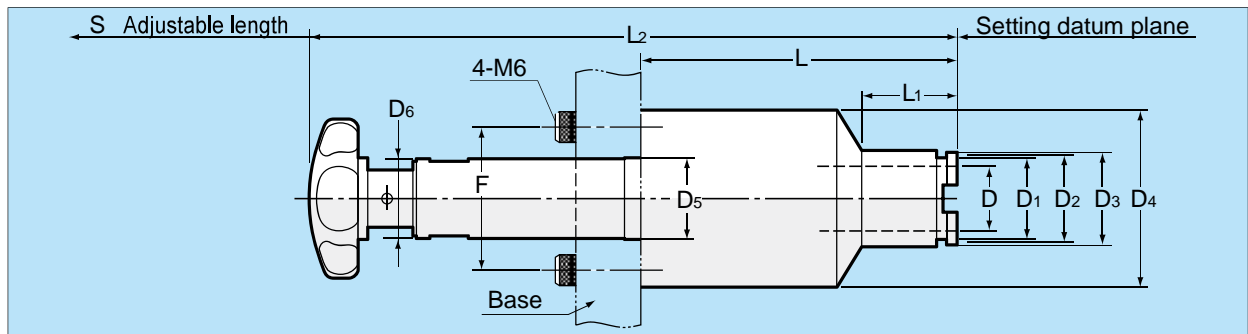

Model	D	D1	D2	D3	D4	D5	D6	L	L1	L2	F	S	kg
-KH12AR	12	16.5	18	20				79.5		182			1.2
-KH14AR	14	20	22	24									1.2
-KH16A	16	24	26.4	29				88		190.5			1.4
-KH19A	19	27	29.4	32				98		200.5			1.5
-KH20A	20												1.5
-KH22A	22	30	32.4	35				104		206.5			1.6
-KH24A	24	32	34.4	37									1.6
-KH25A	25	35	37.4	41	55	25	24		30		45	45	1.9
-KH26A	26							118		220.5			1.8
-KH28A	28	38	40.4	44									1.8
-KH30A	30												1.8
-KH32A	32	41	43.8	47									2.0
-KH35A	35	45	47.8	52				137		239.5			1.9
-KH36A	36												1.9
-KH48A	48	62	65.4	68	70			158.5		261			3.1

• All dimensions shown in millimeters.

Simple Setter SPK-KHA (for KH-A, KH-E Stub Holder)

Base PBK

Type 1

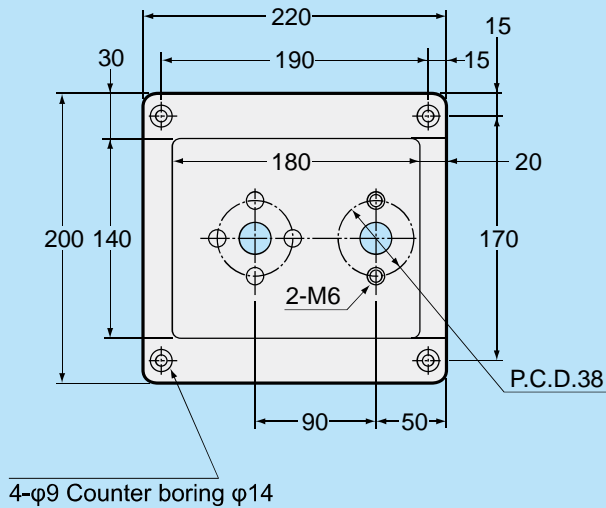

Type 2

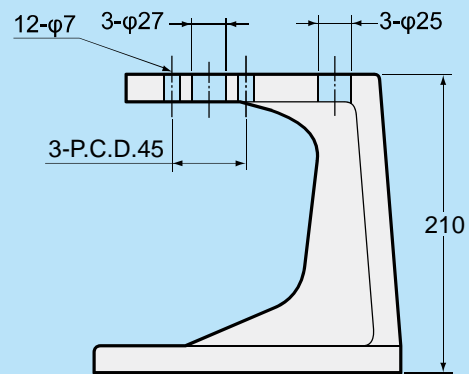
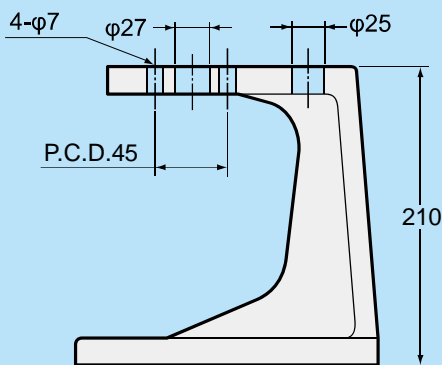
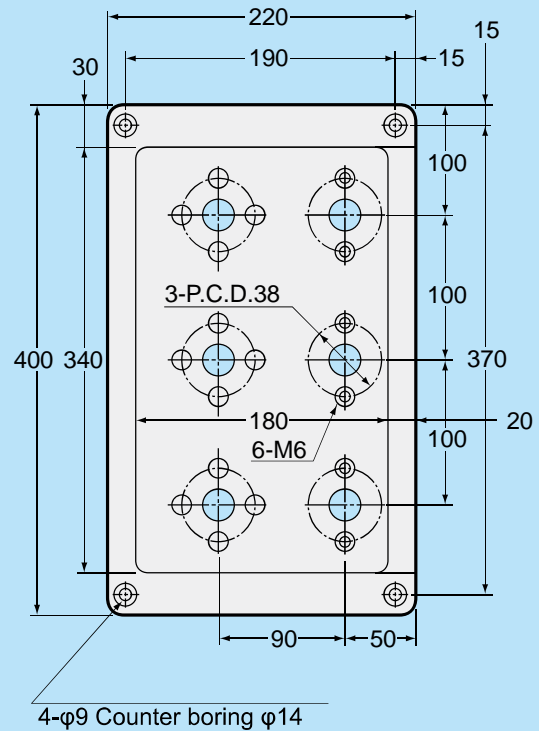

Model	Type	Holder support	Gauge stand
PBK	-1-45	PH-KH12AR~PH-KH48A	PS-1~PS-5
	-2-45		

• All dimensions shown in millimeters.