

# Face Mill Arbor CAT / FMA

**Feature** Special anti-rust surface treatment

**Type 1**

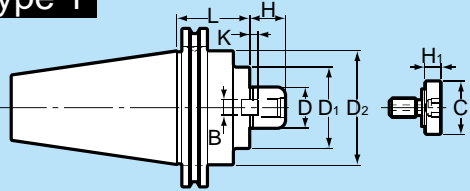

**Type 4**

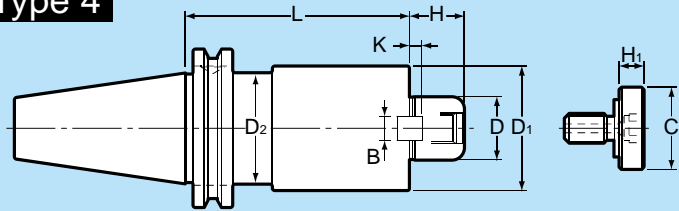

**Type 2**

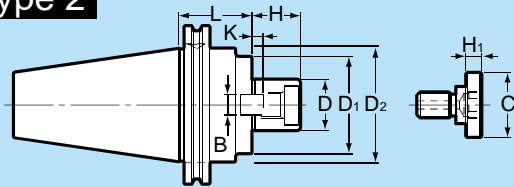

**Type 5**

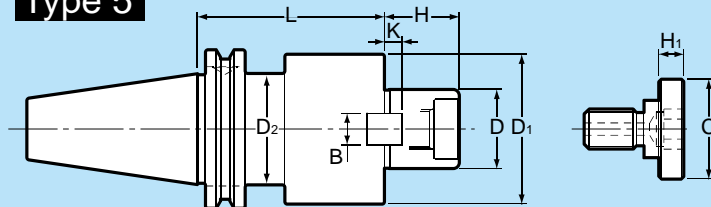

**Type 3**

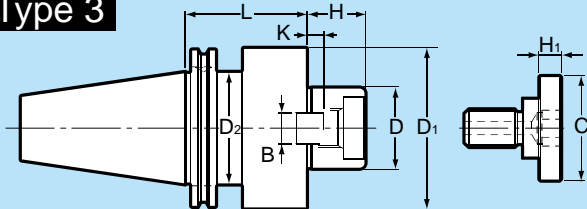

**Type 6**

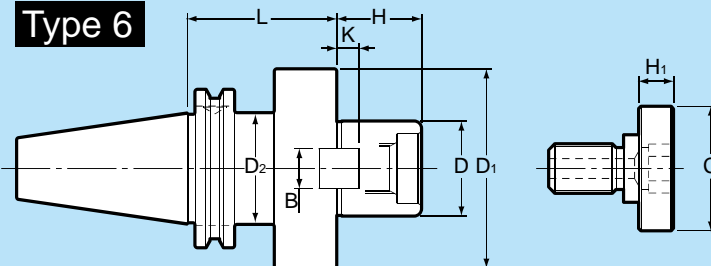

# Face Mill Arbor CAT / FMA

Part Number	Type	Dh6	L	D <sub>1</sub>	D <sub>2</sub>	H	B	K	C	H <sub>1</sub>	Bolt	
CAT40	-FMA19.05- 45	1	1.772	1.772	1.750	0.630	0.315	0.138	0.874	0.354	MBA-M10	
	-FMA19.05- 60		2.362									
	-FMA19.05- 90		3.543									
	-FMA25.4 - 45	4	1.000	1.772	1.969	1.750	0.866	0.374	0.197	1.299	0.394	MBA-M12
	-FMA25.4 - 90		3.543									
	-FMA31.75- 45	5	1.250	1.772	2.362	2.750	1.181	0.500	0.276	1.575	0.551	MBA-M16
	-FMA31.75- 75		2.953									
	-FMA38.1 - 60	6	1.500	2.362	3.150	2.750	1.339	0.626	0.354	1.969	0.551	MBA-M20
-FMA38.1 - 90	3.543											
CAT50	-FMA25.4 - 45	1	1.772	1.969	2.750	0.866	0.374	0.197	1.299	0.394	MBA-M12	
	-FMA25.4 - 90		3.543									
	-FMA25.4 -150		5.906									
	-FMA31.75- 45	2	1.250	1.772	2.362	2.750	1.181	0.500	0.276	1.575	0.551	MBA-M16
	-FMA31.75- 75		2.953									
	-FMA31.75-105	2	1.500	4.134	3.150	2.750	1.339	0.626	0.354	1.969	0.551	MBA-M20
	-FMA38.1 - 45		1.772									
	-FMA38.1 - 75	3	2.000	2.953	3.937	2.750	1.417	0.750	0.394	2.559	0.551	MBA-M24
-FMA50.8 - 45	1.772											
-FMA50.8 - 75	2.953											

Ordering Example

CAT40-FMA25.4-90

# Face Mill Arbor B T / F M A

**Feature** Special anti-rust surface treatment

**Type 1**

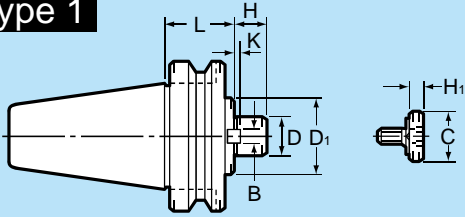

**Type 6**

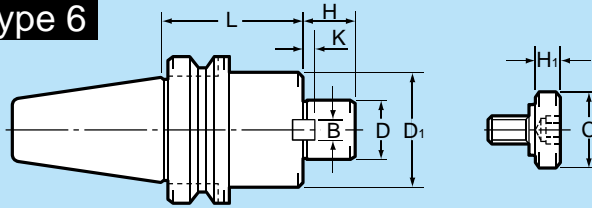

**Type 2**

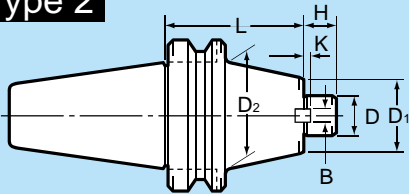

**Type 7**

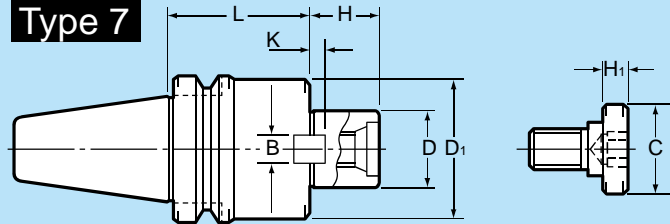

**Type 3**

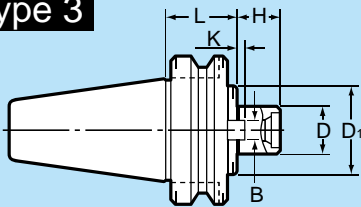

**Type 8**

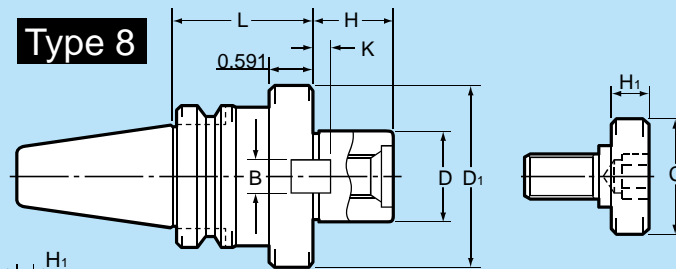

**Type 4**

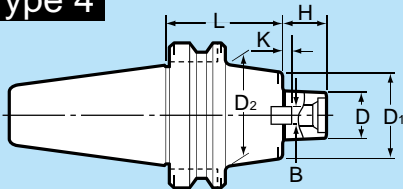

**Type 9**

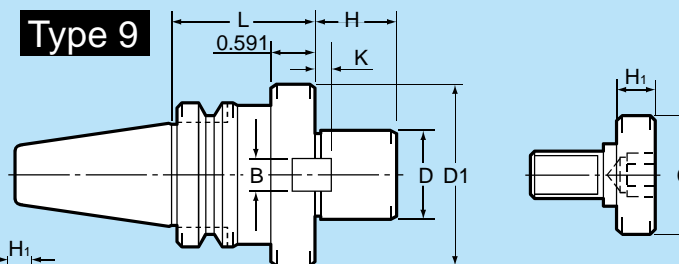

**Type 5**

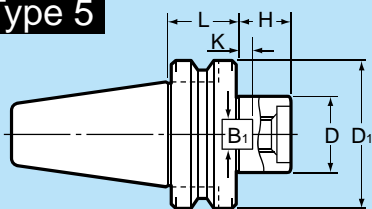

# Face Mill Arbor B T / F M A

Part Number	Type	Dh6	L	D <sub>1</sub>	D <sub>2</sub>	H	B	K	C	H <sub>1</sub>	Bolt	
BT30	-FMA19.05- 45	0.750	<u>1.772</u>	1.772	—	0.630	0.315	0.138	0.874	0.354	MBA-M10	
	-FMA19.05- 60		<u>2.362</u>									
	-FMA19.05- 90		<u>3.543</u>									
	-FMA25.4 - 45	1.000	<u>1.772</u>	1.969	—	0.866	0.374	0.197	1.299	0.394		MBA-M12
	-FMA25.4 - 60		<u>2.362</u>									
	-FMA25.4 - 90		<u>3.543</u>									
BT40	-FMA19.05- 45	0.750	<u>1.772</u>	1.772	—	0.630	0.315	0.138	0.874	0.354	MBA-M10	
	-FMA19.05- 60		<u>2.362</u>									
	-FMA19.05- 90		<u>3.543</u>									
	-FMA25.4 - 45	1.000	<u>1.772</u>	1.969	—	0.866	0.374	0.197	1.299	0.394		MBA-M12
	-FMA25.4 - 60		<u>2.362</u>									
	-FMA25.4 - 90		<u>3.543</u>									
	-FMA31.75- 45	1.250	<u>1.772</u>	2.362	—	1.181	0.500	0.276	1.575	—	MBA-M16	
	-FMA31.75- 75		<u>2.953</u>									
-FMA38.1 - 60	1.500	<u>2.362</u>	3.150	—	1.339	0.626	0.354	1.969	0.551	MBA-M20		
-FMA38.1 - 90		<u>3.543</u>										
BT50	-FMA25.4 - 45	1.000	<u>1.772</u>	1.969	2.756	0.866	0.374	0.197	1.299	0.394	MBA-M12	
	-FMA25.4 - 90		<u>3.543</u>									
	-FMA25.4 -150		<u>5.906</u>									
	-FMA31.75- 45	1.250	<u>1.772</u>	2.362	2.756	1.181	0.500	0.276	1.575	—		MBA-M16
	-FMA31.75- 75		<u>2.953</u>									
	-FMA31.75-105		<u>4.134</u>									
	-FMA38.1 - 45	1.500	<u>1.772</u>	3.150	—	1.339	0.626	0.354	1.969	—	MBA-M20	
	-FMA38.1 - 75		<u>2.953</u>									
	-FMA50.8 - 45	2.000	<u>1.772</u>	3.937	—	1.417	0.750	0.394	2.559	0.551	MBA-M24	
-FMA50.8 - 75	<u>2.953</u>											

Ordering Example

BT40-FMA25.4-90

# Face Mill Arbor H S K / F M A

**Feature** Special anti-rust surface treatment

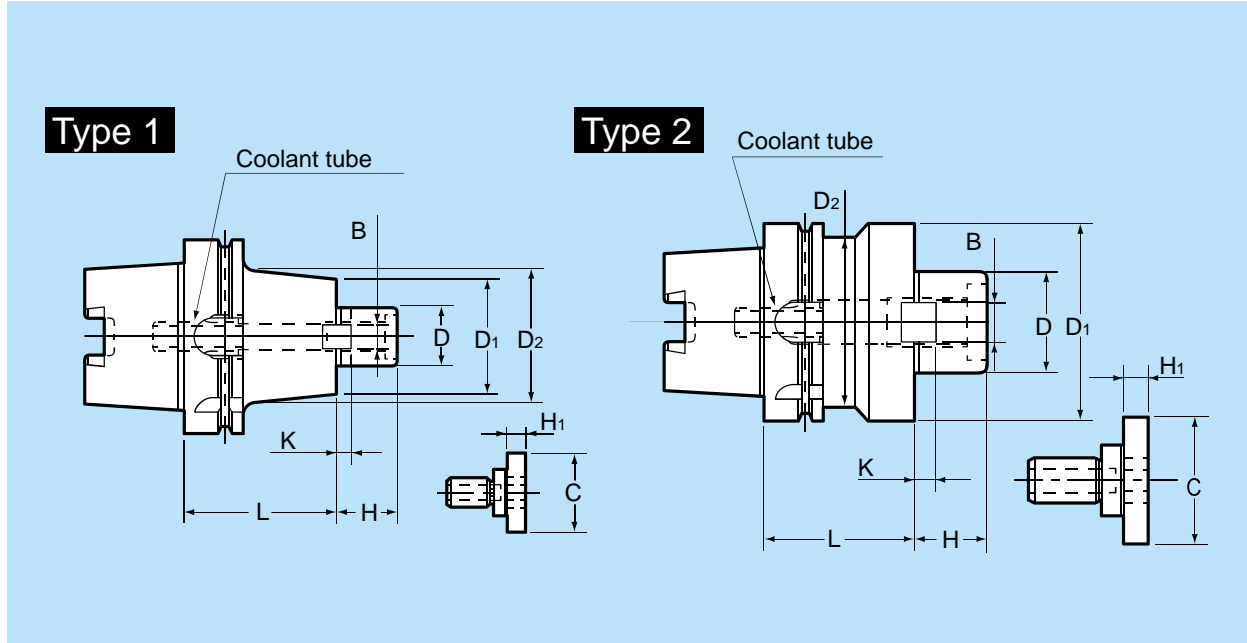

Part Number	Type	Dh6	L	D <sub>1</sub>	D <sub>2</sub>	H	B	K	C	H <sub>1</sub>	Bolt		
HSK40A	2	-FMA19.05- 60	0.750	2.362	1.772	1.339	0.630	0.315	0.138	0.874	0.354	MBA-M10	
		-FMA25.4 - 60	1.000	2.362	1.969		0.866	0.374	0.197	1.299	0.394	MBA-M12	
HSK63A	1	-FMA19.05- 60	0.750	2.362	1.772	1.339	0.630	0.315	0.138	0.874	0.354	MBA-M10	
		-FMA19.05- 90		3.543									
		-FMA25.4 - 60		2.362									
		-FMA25.4 - 90	1.000	3.543	1.969	1.969	0.866	0.374	0.197	1.299		MBA-M12	
HSK63A	2	-FMA25.4 -120		4.724							0.394		
		-FMA31.75- 60		2.362									
		-FMA31.75- 90	1.250	3.543	2.362	2.087	1.181	0.500	0.276	1.575		MBA-M16	
		-FMA31.75-120		4.724									
		-FMA38.1 - 60		2.362									
		-FMA38.1 - 90	1.500	3.543	3.150	2.087	1.339	0.626	0.354	1.969	0.551	MBA-M20	
HSK100A	1	-FMA38.1 -120		4.724									
		-FMA25.4 - 75		2.953									
		-FMA25.4 -105	1.000	4.134	1.969		0.866	0.374	0.197	1.299		MBA-M12	
		-FMA25.4 -135		5.315									
		-FMA31.75- 75		2.953		2.756					0.394		
		-FMA31.75-105	1.250	4.134	2.362		1.181	0.500	0.276	1.575		MBA-M16	
	HSK100A	2	-FMA31.75-135		5.315								
			-FMA38.1 - 75		2.953								
			-FMA38.1 -105	1.500	4.134	3.150	3.150	1.339	0.626	0.354	1.969		MBA-M20
			-FMA38.1 -135		5.315								
			-FMA50.8 - 75		2.953							0.551	
			-FMA50.8 -105	2.000	4.134	3.898	3.268	1.417	0.750	0.394	2.559		MBA-M24
		5.315											

## Ordering Example

HSK63A-FMA25.4-90

- Coolant tube built-in.