

Face Mill Arbor CAT / FMA

Feature Special Anti-rust surface treatment

Type 1

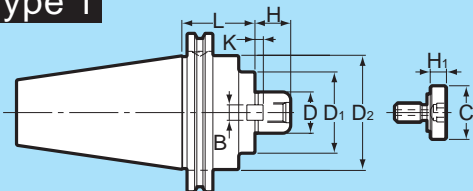

Type 4

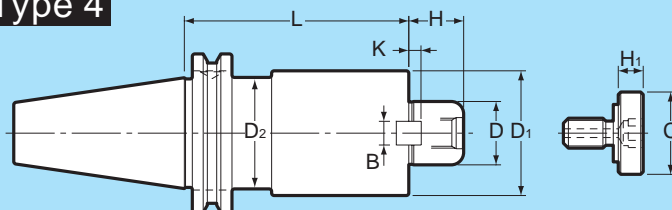

Type 2

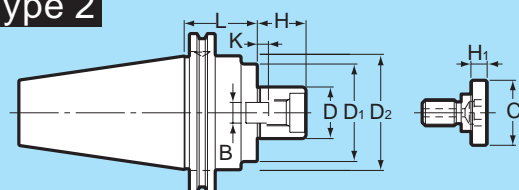

Type 5

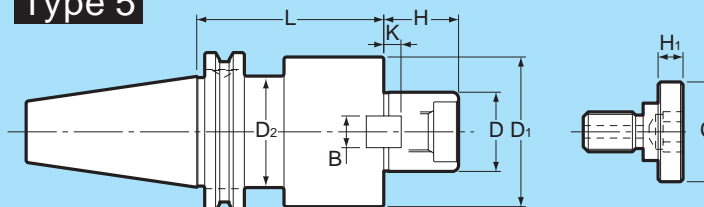

Type 3

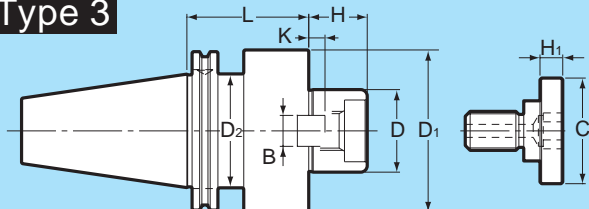

Type 6

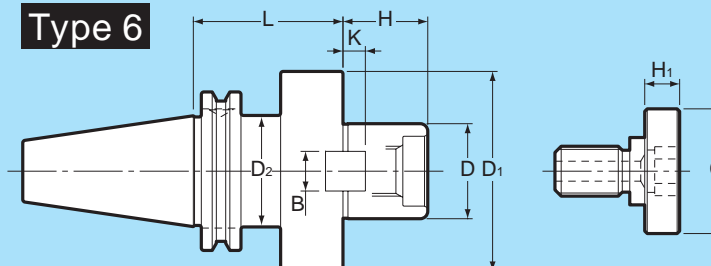

Face Mill Arbor CAT / FMA

Part Number	Type	Dh6	L	D ₁	D ₂	H	B	K	C	H ₁	Bolt	
CAT40	1	0.750	1.772	1.772	1.750	0.630	0.315	0.138	0.874	0.354	MBA-M10	
			2.362									
			3.543									
	4	1.000	1.000	1.772	1.969	1.750	0.866	0.374	0.197	1.299	0.394	MBA-M12
				3.543								
	5	1.250	1.250	1.772	2.362	2.750	1.181	0.500	0.276	1.575	0.551	MBA-M16
				2.953								
6	1.500	1.500	2.362	3.150	3.543	1.339	0.626	0.354	1.969	0.551	MBA-M20	
			3.543									
CAT50	1	1.000	1.772	1.969	2.750	0.866	0.374	0.197	1.299	0.394	MBA-M12	
			3.543									
	2	1.250	1.250	1.772	2.362	2.750	1.181	0.500	0.276	1.575	0.551	MBA-M16
				2.953								
	2	1.500	1.500	4.134	3.150	3.543	1.339	0.626	0.354	1.969	0.551	MBA-M20
				1.772								
	3	2.000	2.000	2.953	3.937	4.134	1.417	0.750	0.394	2.559	0.551	MBA-M24
				1.772								

Ordering Example CAT40-FMA25.4-90

Face Mill Arbor B T / F M A

Feature Special Anti-rust surface treatment

Type 1

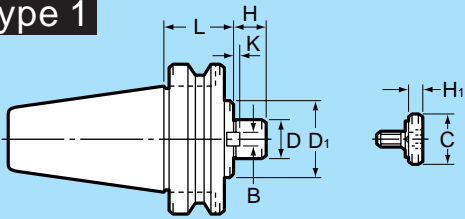

Type 6

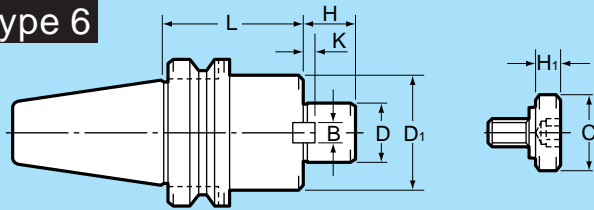

Type 2

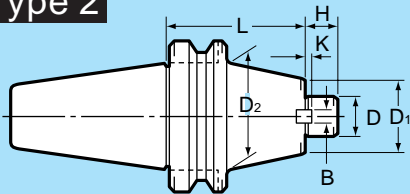

Type 7

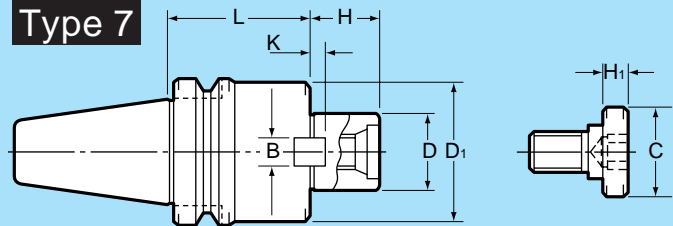

Type 3

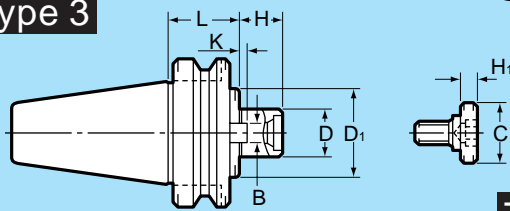

Type 8

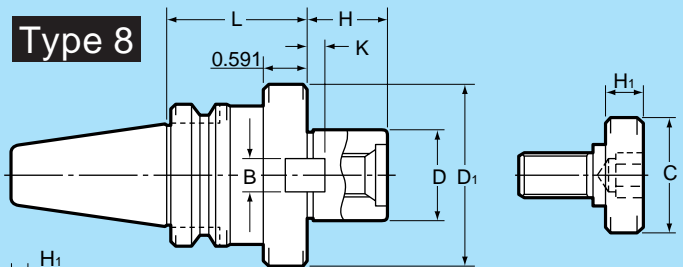

Type 4

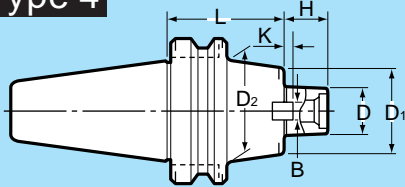

Type 9

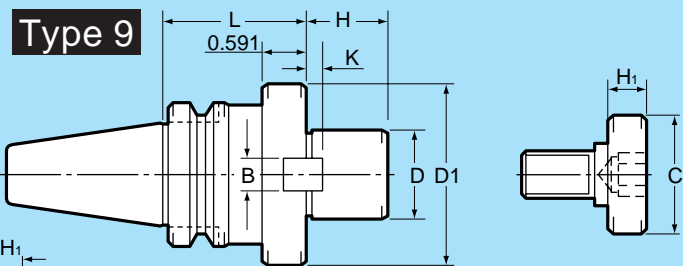

Type 5

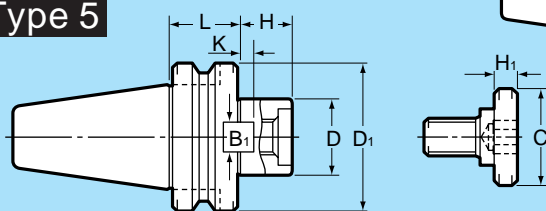

Face Mill Arbor BT / FMA

Part Number	Type	Dh6	L	D ₁	D ₂	H	B	K	C	H ₁	Bolt		
BT 30	-FMA19.05- 45	9	<u>1.772</u>	1.772		0.630	0.315	0.138	0.874	0.354	MBA-M10		
	-FMA19.05- 60		0.750									<u>2.362</u>	
	-FMA19.05- 90											<u>3.543</u>	
	-FMA25.4 - 45		1.000									<u>1.772</u>	1.969
	-FMA25.4 - 60											<u>2.362</u>	
	-FMA25.4 - 90											<u>3.543</u>	
BT 40	-FMA19.05- 45	6	<u>1.772</u>	1.772		0.630	0.315	0.138	0.874	0.354	MBA-M10		
	-FMA19.05- 60		0.750									<u>2.362</u>	
	-FMA19.05- 90											<u>3.543</u>	
	-FMA25.4 - 45	7	<u>1.772</u>	1.969		0.866	0.374	0.197	1.299	0.394	MBA-M12		
	-FMA25.4 - 90		1.000									<u>3.543</u>	
	-FMA31.75- 45	7	<u>1.772</u>	2.362		1.181	0.500	0.276	1.575		MBA-M16		
	-FMA31.75- 75		1.250									<u>2.953</u>	
	-FMA38.1 - 60	8	<u>2.362</u>	3.150		1.339	0.626	0.354	1.969	0.551	MBA-M20		
-FMA38.1 - 90	1.500		<u>3.543</u>										
BT 50	-FMA25.4 - 45	1	<u>1.772</u>	1.969	2.756	0.866	0.374	0.197	1.299	0.394	MBA-M12		
	-FMA25.4 - 90	2	1.000									<u>3.543</u>	
	-FMA25.4 -150		<u>5.906</u>										
	-FMA31.75- 45	3	<u>1.772</u>	2.362	2.756	1.181	0.500	0.276	1.575		MBA-M16		
	-FMA31.75- 75	4	1.250									<u>2.953</u>	
	-FMA31.75-105	4		<u>4.134</u>									
	-FMA38.1 - 45	3	<u>1.772</u>	3.150		1.339	0.626	0.354	1.969	0.551	MBA-M20		
	-FMA38.1 - 75		1.500									<u>2.953</u>	
	-FMA50.8 - 45	5	<u>1.772</u>	3.937		1.417	0.750	0.394	2.559		MBA-M24		
-FMA50.8 - 75	2.000		<u>2.953</u>										

Ordering Example BT40-FMA25.4-90

Face Mill Arbor H S K / F M A

Feature

Special Anti-rust surface treatment

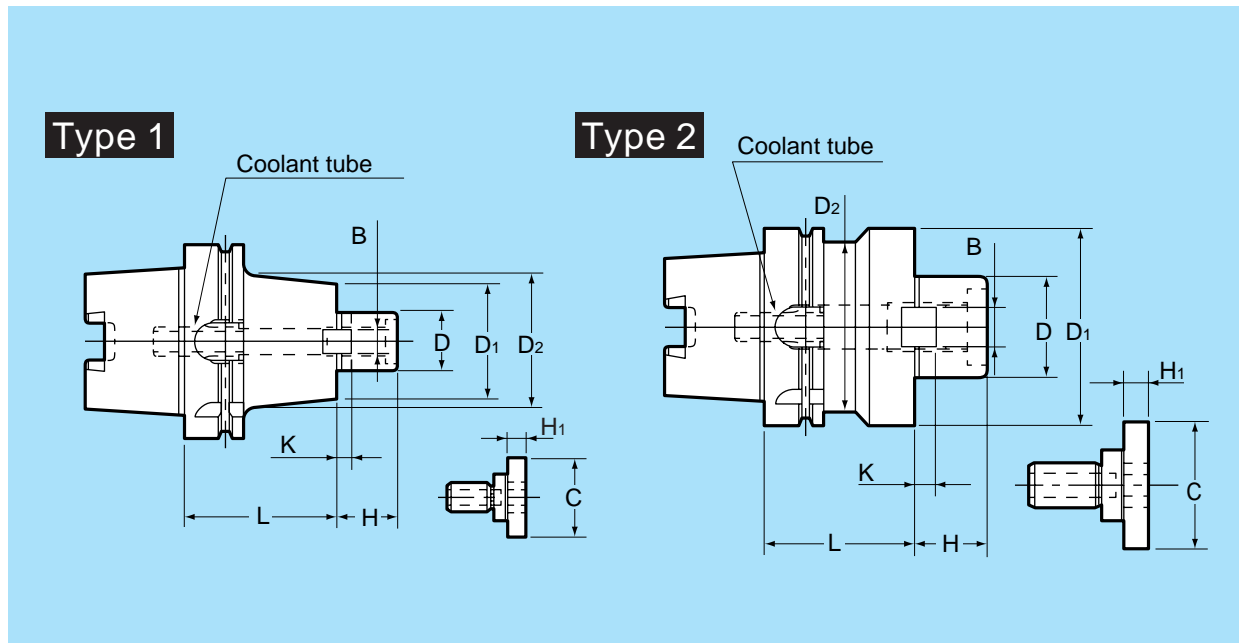

Part Number	Type	Dh6	L	D ₁	D ₂	H	B	K	C	H ₁	Bolt						
HSK40A	2	-FMA19.05- 60	0.750	2.362	1.772	1.339	0.630	0.315	0.138	0.874	0.354	MBA-M10					
		-FMA25.4 - 60	1.000	2.362	1.969		0.866	0.374	0.197	1.299	0.394	MBA-M12					
HSK63A	1	-FMA19.05- 60	0.750	2.362	1.772	1.339	0.630	0.315	0.138	0.874	0.354	MBA-M10					
		-FMA19.05- 90	1.000	3.543	1.969								1.969	0.866	0.374	0.197	1.299
		-FMA25.4 - 60		2.362													
	-FMA25.4 - 90	3.543	1.969	1.969	0.866	0.374	0.197	1.299	MBA-M12								
	-FMA25.4 -120	4.724							0.394								
-FMA31.75- 60	1.250	2.362	2.362	2.087	1.181	0.500	0.276	1.575	MBA-M16								
HSK63A	2	-FMA31.75- 90	1.250	3.543	2.362	2.087	1.181	0.500	0.276	1.575	0.394	MBA-M16					
		-FMA31.75-120	1.500	4.724	3.150								2.087	1.339	0.626	0.354	1.969
		-FMA38.1 - 60		2.362													
-FMA38.1 - 90	3.543	3.150	2.087	1.339	0.626	0.354	1.969	0.551	MBA-M20								
-FMA38.1 -120	4.724																
HSK100A	1	-FMA25.4 - 75	1.000	2.953	1.969	2.756	0.866	0.374	0.197	1.299	0.394	MBA-M12					
		-FMA25.4 -105		4.134													
		-FMA25.4 -135		5.315													
		-FMA31.75- 75		2.953													
	-FMA31.75-105	1.250	4.134	2.362	1.181	0.500	0.276	1.575	MBA-M16								
	-FMA31.75-135	5.315															
	-FMA38.1 - 75	1.500	2.953	3.150	3.150	1.339	0.626	0.354	1.969	MBA-M20							
	-FMA38.1 -105	4.134	3.150	3.150	1.339	0.626	0.354	1.969	0.551								
	-FMA38.1 -135	5.315															
	-FMA50.8 - 75	2.000	2.953	3.898	3.268	1.417	0.750	0.394	2.559	MBA-M24							
-FMA50.8 -105	4.134	3.898	3.268	1.417	0.750	0.394	2.559										
-FMA50.8 -135	5.315																

Ordering Example

HSK63A-FMA25.4-90

HSK63A-H-FMA25.4-90 (HSK Type A with manual clamping hole.)

Coolant tube built-in.