

Endmill Chuck PAT.

EM • A

Application

- Small end milling
- Extension for milling chuck

Feature

No Rust — Special Surface Treatment

- No rust under normal use conditions.
No deterioration of precision due to rust.
- Both shanks and collets are available in great assortments.
A large number of combinations are possible for various needs.



System Chart

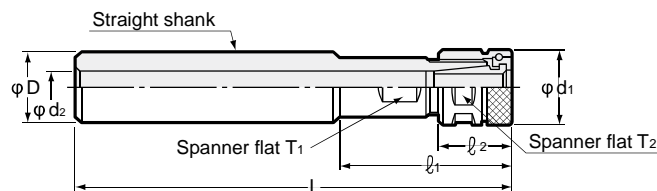
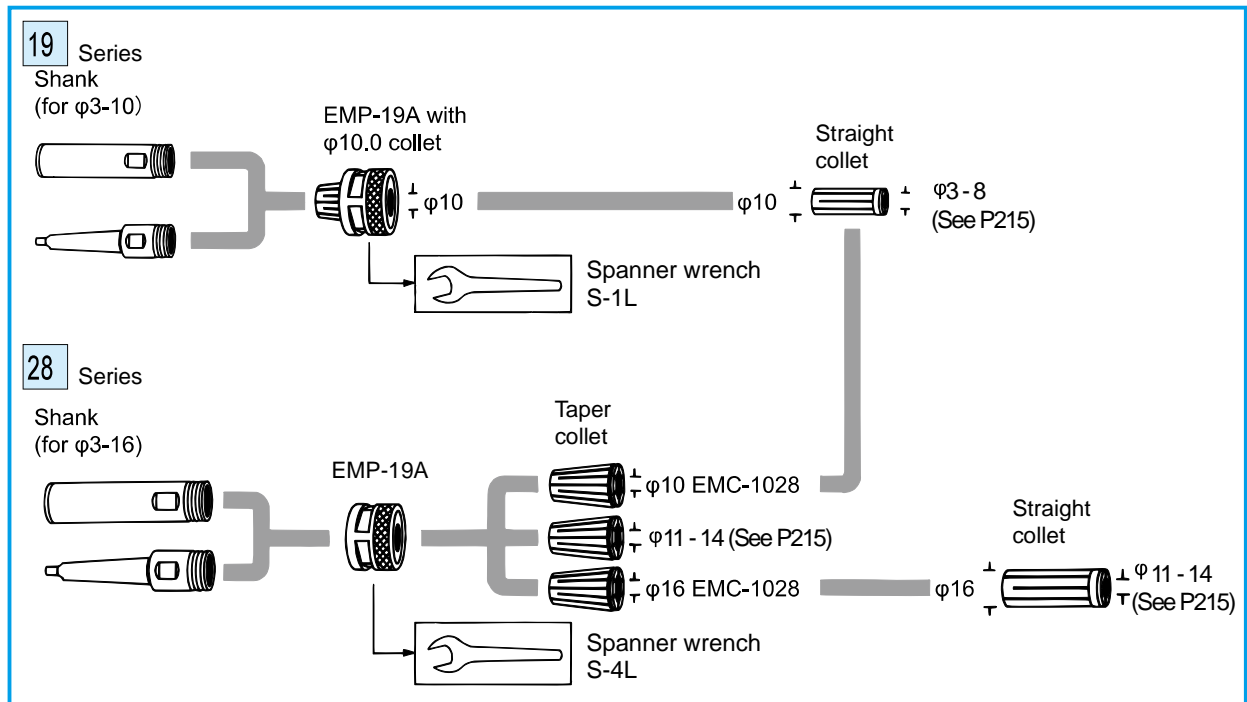

Part Number	Series	Chucking range	D _{h7}	MT	d ₁	d ₂	L	l ₁	l ₂	T ₁	T ₂	Nut				
EM	-1619A	19	3 - 10	16	—	26	11.5	100	50	20	17	24	EMP-19A			
	-2019A			20	—									125		
	-2219A			22	—									150	65	22
	-2519A			25	—									175	80	
	-3219A			32	—											
	-4219A			42	—											

• All dimensions shown in millimeters.

Endmill Chuck PAT.

EM • A

Part Number	Series	Chucking range	D _{h7}	MT	d ₁	d ₂	L	ℓ ₁	ℓ ₂	T ₁	T ₂	Nut
EM -T119A	19	3 - 10	—	1	26	—	120	58	20	17	24	EMP-19A
-T219A			—	2		—	150	75				
-T319A			—	3		—	180	86				
EM -2028A	28	3 - 16	20	—	36	11.5	125	60	25	27	33	EMP-28A
-2228A			22	—								
-2528A			25	—								
-25428A			25.4	—								
-3028A			30	—		150						
-317528A			31.75	—								
-3228A			32	—		175						
-3528A			35	—								
-4228A			42	—								
-T228A			—	2		—	150	75				
-T328A			—	3		—	180	86				
-T428A			—	4		—	205	87.5				

• All dimensions shown in millimeters.

Ordering Example

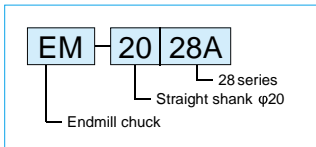

- Endmill includes nut.
- Collet and spanner wrench are sold separately. (Page 227)

Straight collet

For 19 series

Part Number	I.D.
EMS -0310	φ3
-03510	3.5
-0410	4
-0510	5
-0610	6
-07710	7.7
-0810	8

Taper collet

For 28 series

Part Number	I.D.
EMC -1028	10.0
-1128	11.0
-1228	12.0
-12528	12.5
-1328	13.0
-1428	14.0
-1628	16.0

Special Spanner Wrench

NT spanner wrenches are manufactured to factory specifications and dimensions to achieve optimal clamping force. Use of NT spanner wrenches on NT products prevents over-tightening and breakage. NT spanner wrench flats are made to NT specifications, conventional spanner wrenches may not work on NT products.



Size	Nut	T ₂	L
S	-1L	EMP-19A	24 180
	-4L	EMP-28A	33 220

Straight collet

For 28 series

Part Number	I.D.
EMS -0516	5.0
-0616	6.0
-07716	7.7
-0816	8.0
-0916	9.0
-1016	10.0
-1116	11.0
-1216	12.0
-12516	12.5
-1316	13.0
-1416	14.0

Endmill Chuck PAT.

EM • A

Set for 19 Series — Each set includes spanner and collet.

Contents of Set

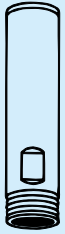
19 Series	Part Number	S E T	Nut with collet	Straight collet				
			EMP-19A	EMS-0810	EMS-0610	EMS-0510	EMS-0410	EMS-0310
			φ 10	φ 8	φ 6	φ 5	φ 4	φ 3
 STRAIGHT EM-	1619A	B	○	○	○			
		C	○	○	○	○	○	○
	2019A	B	○	○	○			
		C	○	○	○	○	○	○
	2219A	B	○	○	○			
		C	○	○	○	○	○	○
	2519A	B	○	○	○			
		C	○	○	○	○	○	○
	3219A	B	○	○	○			
		C	○	○	○	○	○	○
	4219A	B	○	○	○			
		C	○	○	○	○	○	○

• All dimensions shown in millimeters.

Ordering Example

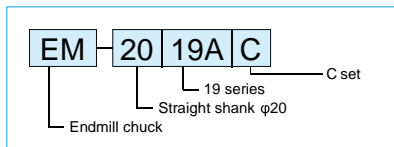

Endmill Chuck PAT.

EM • A

Set for 19 Series

Contents of Set

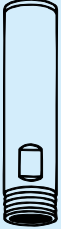
28 Series	Part Number	S E T	Nut EMP-28A	Taper collet		Straight collet			
				EMC-1628	EMS-1216	EMS-1016	EMS-0816	EMS-0616	EMS-0516
				φ 16	φ 12	φ 10	φ 8	φ 6	φ 5
 STRAIGHT EM-	2028A	B	○	○	○	○			
		C	○	○	○	○	○	○	○
	2228A	B	○	○	○	○			
		C	○	○	○	○	○	○	○
	2528A	B	○	○	○	○			
		C	○	○	○	○	○	○	○
	25428A	B	○	○	○	○			
		C	○	○	○	○	○	○	○
	3028A	B	○	○	○	○			
		C	○	○	○	○	○	○	○
	317528A	B	○	○	○	○			
		C	○	○	○	○	○	○	○
	3228A	B	○	○	○	○			
		C	○	○	○	○	○	○	○
	3528A	B	○	○	○	○			
		C	○	○	○	○	○	○	○
4228A	B	○	○	○	○				
	C	○	○	○	○	○	○	○	

HOW TO INSERT the taper collet into the nut (28 series).

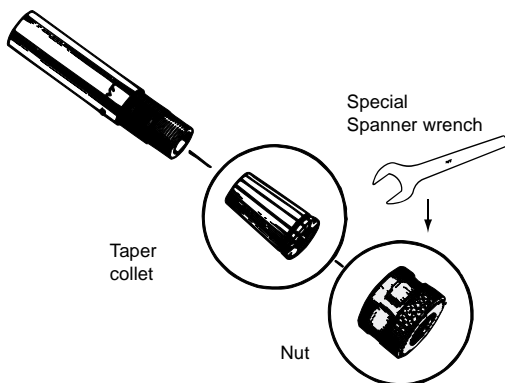

How to insert:

Align collet and nut.
Then push nut down
hard.

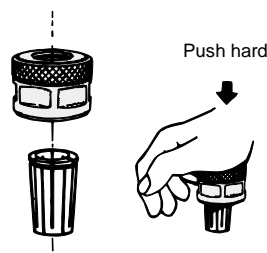

How to remove:

Push collet sideways,
while holding nut
securely.

